



INSTALLATION INSTRUCTIONS FOR PART 95-9307B

INSTALLATION INSTRUCTIONS FOR PART 95-9307B

APPLICATIONS BMW 5 SERIES 1997-2003

95-9307B

KIT FEATURES

- DDIN Head Unit Provision
- ISO Stacked Head Unit Provision
- Painted Scratch Resistant Matte Black



KIT COMPONENTS

- DDIN Radio Housing • DDIN Radio Trim Plate • DDIN Brackets • (4) PC-7503 Panel Clips
- (8) PFH-12MM Flush Mount ISO Screws • (2) PPH-12 Phillips Screws

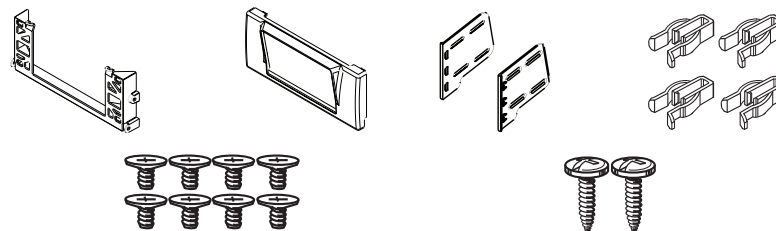

TOOLS REQUIRED

- Phillips Screwdriver • Torx Screwdriver • Panel Removal Tool
- Small Flat Blade Screwdriver • Cutting Tool or File • Socket Wrench

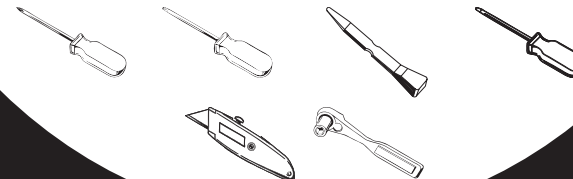

METRA. THE WORLD'S BEST KITS.™



1-800-221-0932



metraonline.com

© COPYRIGHT 2004-2010 METRA ELECTRONICS CORPORATION

METRA. THE WORLD'S BEST KITS.™



1-800-221-0932



metraonline.com

© COPYRIGHT 2004-2010 METRA ELECTRONICS CORPORATION

REV. 1/25/2010

95-9307B KIT ASSEMBLY

95-9307B DASH DISASSEMBLY

BMW 5 SERIES 1997-2003

- 1** Mount the DDIN housing into the radio cavity using the supplied (2) PPH-12 Phillips screws and (2) factory screws removed in disassembly. (Fig. A)
- 2** Locate the factory wiring harness in the dash. Metra recommends using the proper mating adapters from Metra and AXCESS to integrate your new radio. Re-connect the negative battery terminal and test the unit for proper operation.
- 3** Mount the DDIN radio to the supplied DDIN brackets using the supplied (8) ISO screws. (Fig. B)
- 4** Mount the radio into the dash opening.
- 5** Push the included snaps onto the legs of the DDIN Radio trim plate. (Fig. C)
- 6** Snap the DDIN trim plate over the radio.
- 7** Reassemble dash in reverse order of disassembly.

A

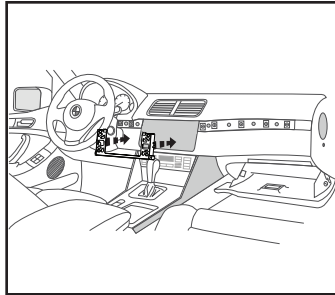

B

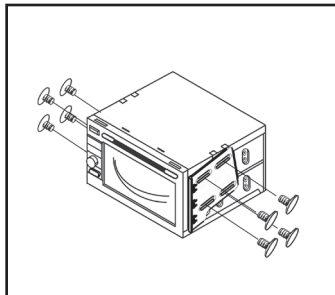

C

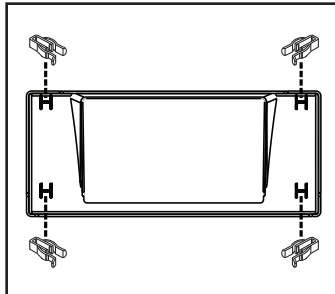

BMW 5 SERIES 1997-2003

- 1** Disconnect the negative battery terminal to prevent an accidental short circuit.
- 2** Remove the volume by pulling out towards the rear of the vehicle.
- 3** Using a T-10 Torx screwdriver to turn the release screw 90° behind the volume knob then pull out on the bottom of the radio and remove. (Fig. A)
Note: Leave the Torx driver in place to aid in pulling out on the radio.
- 4** Disconnect the wiring.
- 5** Remove (2) T-10 Torx screws securing the top of the factory radio then unclip and remove. (Fig. B)
- 6** Disconnect the wiring.
- 7** Unclip and remove the wood trim above the glove box and to the left of the radio. (Fig. C)

A

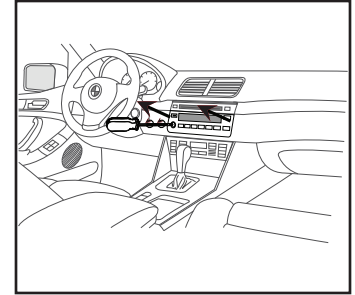

B

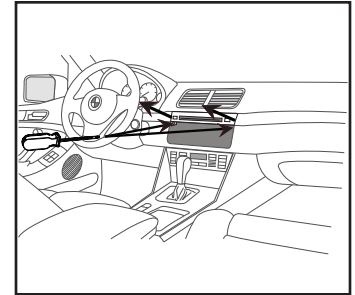

C

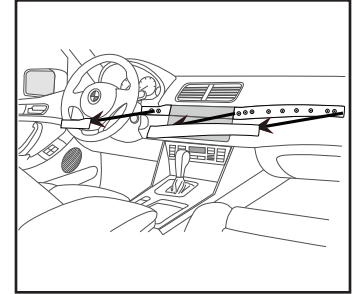

Continued on Pg. 2

95-9307B DASH DISASSEMBLY

95-9307B DASH DISASSEMBLY

BMW 5 SERIES 1997-2003

BMW 5 SERIES 1997-2003

.....Continued from Pg. 1

.....Continued from Pg. 2

- 8** Remove the Phillips screws securing the (2) side panels on the center console then slide the panels forward to unclip and remove them. (Fig. D)

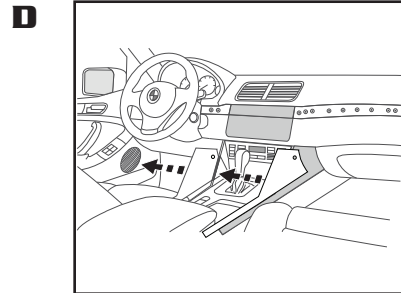

- 9** Unclip and remove the (2) glove box side supports with the glove box open. (Fig. E)

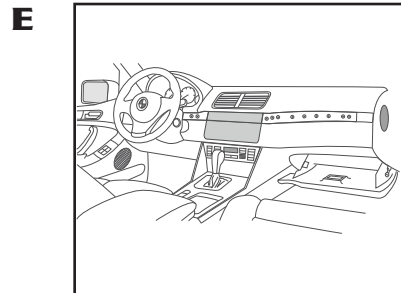

- 10** Remove (2) Phillips screws securing the panel on the inside left hand side of the glove box then remove the panel. (Fig. F)

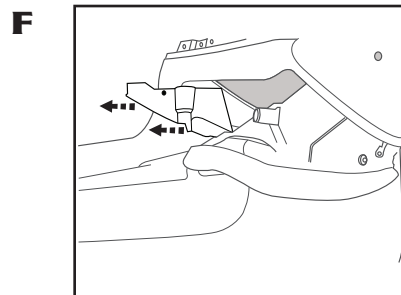

Continued on Pg. 3

- 11** Remove the Phillips screws securing the glove box to the lower dash panel and let it hang. (Fig. G)

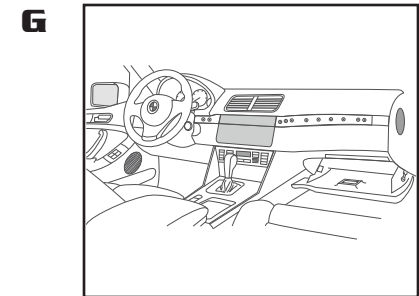

- 12** Remove the Phillips screws above the glove box and the one behind the cover on the side of the lower dash panel. (Fig. H)

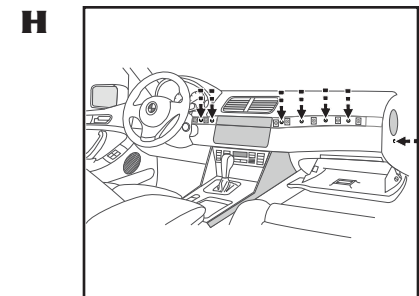

- 13** Remove the two screws on the lower dash panel to the left of the radio. (Fig. H)

- 14** Remove the (4) Phillips screws securing the radio sub dash panel to the lower dash panel. (Fig. I)

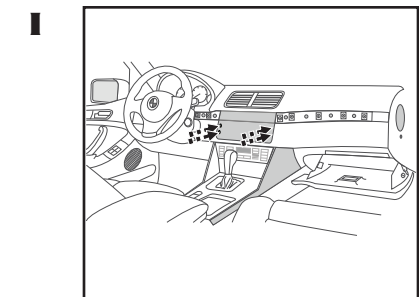

- 15** Pull the right side of the lower dash panel outward to gain access to and remove the radio sub dash panel.

Continue to Kit Assembly.....