

Installation Manual Double DIN Kit 381320-19 / 391320-19



Installation Manual Double DIN Kit

Standard: 381320-19

Rubber-Touch: 391320-19

• Audi TT (8J) 2006 →

Compatible with double DIN devices

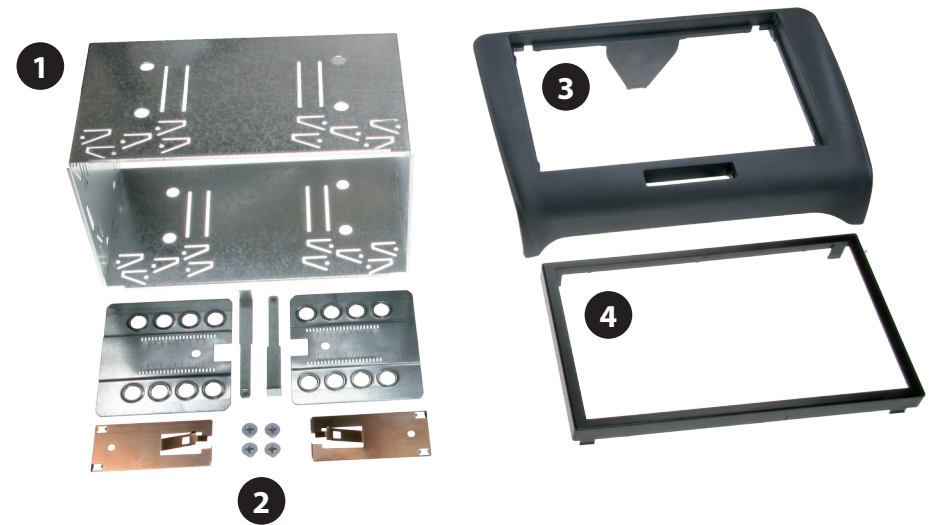

Double DIN Set contents

- (1) Metal Frame
- (2) Installation Kit

- (3) Facia Plate
- (4) Trim Frame

Installation Manual Double DIN Kit 381320-19 / 391320-19



1. Put four radio release keys in the appropriate slots of the OEM radio

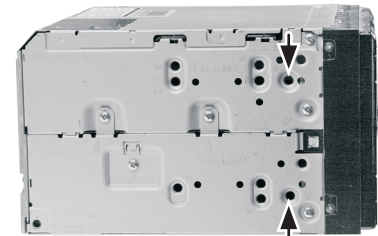

(sample photo)

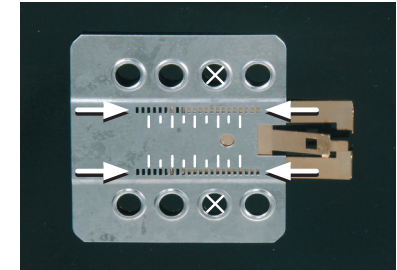

(sample photo)

Mount the metal brackets to the double DIN head unit.

The position of the copper coloured holder can be adjusted to your needs for perfect fit. (see sample)



2. Remove the OEM head unit by pulling it towards your direction.
3. Place the mounting frame on the dashboard.

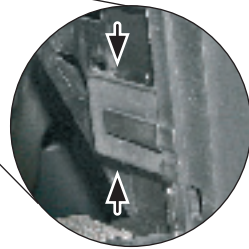

Seat Exeo only: The mounting frame has to be clipped behind the fixed OEM frame (see sample photo)

5. Push the Metal Frame into the fascia plate, place both into the dashboard.

Connect all required circuit points and push the double DIN head unit in the metal frame until it snaps in. Fix the fascia plate with the original screws, place the trim frame.



4. Fix the mounting frame with two screws (see arrows)

Push the Metal Frame into the mounting frame

Reinstall everything in reverse order to finish installation.

*All installation work must be performed by a qualified professional installer only.
The manufacturer / dealer is not liable for any kind of incidental or indirect damages.*